

# JUNG ROCKER SWITCH

**BEFORE** attempting to carry out any electrical work **ALWAYS** isolate the mains supply by switching off at the main consumer board. **CONFIRM** that the part you intend to work on is indeed disconnected from the mains supply by means of a multimeter or similar testing device.

These instructions are purely to aid the proper fitting of the mechanical parts of the switch. Consult your electrician or wiring regulations for guidance on how to correctly wire 2-way or intermediate switches. A basic diagram from the manufacturer is included in the product packaging.

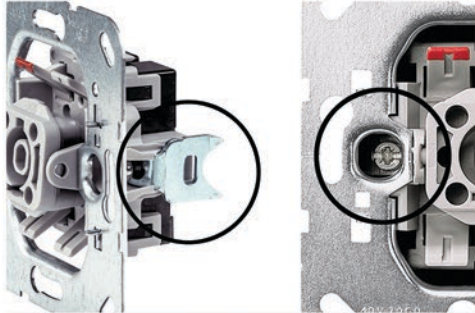

Remove the small clamps on each side of the insert by taking out their small fixing screw with a flat-head screwdriver. This is not strictly necessary but ensures an easier fit in the back boxes.

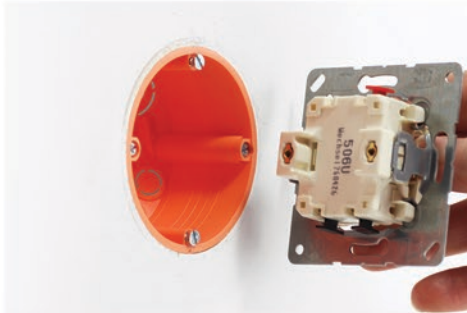

Align the insert with the device screws and make sure they fit neatly into the runners of the insert. (On a standard square box the device screws are usually fixed on the sides, not top and bottom.)

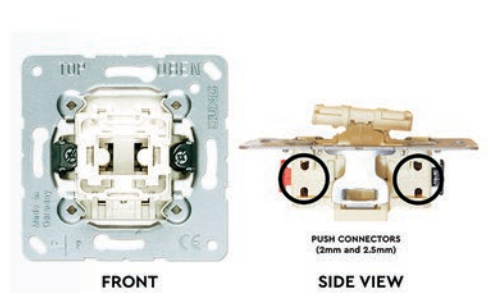

Connect the insert to the existing wiring according to the type of switch, and to local regulations. Connect wires by pushing them firmly into the holes. To remove, push down the release paddle and pull out the wire.

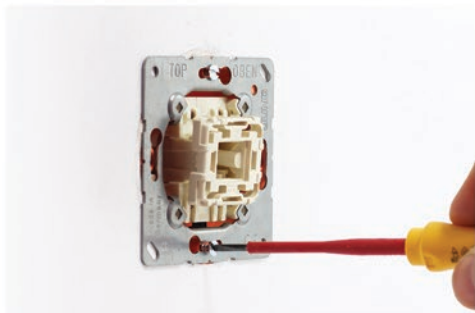

Once the wires are connected, place the insert in the back box, using the runners to straighten it. Secure the insert by tightening the device screws with a flat-head screwdriver.



The frame is placed loosely over the insert. On some models there is a particular rotation that makes the frame slot into place.



Hold the frame in place and align the fixing bracket with the insert. Use this step to ensure that the frame is straight, optionally by using a spirit level. If not, go back 2 steps and make adjustments to the insert.



Push the small plastic bracket firmly into the insert to secure the frame in place. Make sure it goes all the way in and is straight.



The rocker (or rockers, if you are fitting a multi-gang switch) has two prongs that slot into corresponding openings in the insert.



Finally just push the rocker(s) onto the insert until they feel secure and well aligned with the frame. To remove the assembly, gently pull the rocker out - do NOT use a screwdriver or you will damage the frame!

**PLEASE NOTE: SWTCH SELLS WIRING ACCESSORIES. WE ARE NOT QUALIFIED TO GIVE ELECTRICAL ADVICE OR CONSULTATION, BUT WE WILL ALWAYS TRY TO HELP YOU OR YOUR ELECTRICIAN. ELECTRICAL WORK SHOULD BE UNDERTAKEN BY A QUALIFIED INSTALLER OR OTHERWISE COMPETENT PERSON.**